

PREMIER INSULATION



100% POLYESTER UNDERFLOOR INSTALLATION GUIDE

Premier 100% Polyester Insulation is proudly manufactured in NZ from thermally bonded polyester fibres, for use in framed walls, ceilings, suspended floors and mid-floor applications in both residential and commercial construction. Our Polyester Insulation range is available in a range of widths and performance options and is available in blanket, skillion and segment forms and carry a 50-year product durability warranty.

COMPLIANCE STATEMENTS

The total R-Value of the building system depends on the building materials, design and installation and may be less than, greater than, or equal to the declared R-Value of the product.

The initial performance of the insulation material may be reduced if it is stored for too long in its compressed packaging. Should this product be found to be compressed at installation, it will recover to its nominal thickness and R-Value between 48 Hours and up to one month following installation. Premier Polyester Insulation should be removed from its compressed packaging within 6 months from the date of manufacture.

Premier 100% Polyester Insulation will not settle or reduce its performance over time and will meet and exceed the 50 year durability clause of the NZBC (B2.3.1(a)) when installed in accordance with these manufacturer's instructions.

Premier 100% Polyester Insulation is supplied with labelling compliant with AS/NZS4859.1. The nominal thickness, net area, and nominal weight of each pack is recorded on the product bale label.

INSTALLER SAFETY

Premier 100% polyester insulation is completely safe to handle. Premier polyester is non-toxic, non-itchy, and non-allergenic. That means no itchy skin, sore throats, or lung irritation on contact or following installation.

Refer NZS4246:2016 for required insulation clearances to downlights and electrical appliances. In retrofit situations we recommend that the installation process is performed with the power off.

Premier polyester insulation is safe to handle and install without protective clothing, however due to conditions under some homes we recommend long sleeved loose clothing, face mask, goggles and adequate lighting. We also recommend that a comprehensive first aid kit is available on site.

Beware of sharp objects such as broken glass and protruding nails etc., as well as other hazards such as animals and vermin. Check drainage pipes for leaks and have them repaired before starting the installation.

PREMIER INSULATION



100% POLYESTER UNDERFLOOR INSTALLATION GUIDE

ELECTRICAL SAFETY

CAUTION: Electric cables and equipment partially or completely surrounded with any bulk thermal insulation may overheat and fail. This applies to wiring installed prior to 1989.

Before installing Premier Polyester Underfloor Blanket we recommend that you locate and identify all wires and cabling in the underfloor area to reduce the risk of electric shock. Insulation should be installed above electrical wiring leaving all cables and wiring clearly visible.

- Beware of damaged, exposed or hanging cables and wires.
- Contact a registered electrician to complete necessary repairs prior to starting the installation.
- Treat all wires as live. Wherever possible isolate power to the work area before commencing work.
- Do not staple within 50mm of any wiring.
- Avoid covering and/or hiding electrical wires and cables.

INSTALLATION TOOLS

WE RECOMMEND YOU HAVE:

- Sharp wide-blade knife for cutting insulation
- Head torch or appropriate lighting
- Tape measure
- Coveralls, goggles and face mask
- Staple gun with 12-14mm staples
- Basic tool kit (hammer, pliers, screw-drivers, and hack-saw)

PRODUCT SELECTION

Premier Polyester Underfloor Blanket is designed for use in exposed joist floors. Premier Polyester Underfloor Blanket is available in a range of widths and performance options and can be installed in new and existing buildings with enclosed, semi-enclosed and open sub-floor spaces. Choose the product width to best suit the framing size. Joist widths can vary so be sure to measure more than just one. You may need several widths of Premier Polyester Underfloor to complete the job and minimise waste.

Premier Polyester Underfloor @ 450mm wide, ideal for joist spaces up to 430mm

Premier Polyester Underfloor @ 510mm wide, ideal for joist spaces between 430mm and 500mm

Premier Polyester Underfloor @ 600mm wide, ideal for joist spaces between 500mm and 580mm

Premier Polyester Underfloor @ 650mm wide, ideal for joist spaces between 580mm and 630mm

We recommend the use of 12-14mm staples. In coastal areas we recommend you use stainless steel staples to eliminate corrosion, as per the NZBC requirements.

Where wind wash is a concern in exposed open sub-floor spaces we suggest selecting the highest R-Value insulation suitable for the building. In fully open sub-floor spaces, it is recommended that a suitable lining material is also installed.

PREMIER INSULATION



100% POLYESTER UNDERFLOOR INSTALLATION GUIDE

INSTALLATION INSTRUCTIONS

All thermal and acoustic insulation should be installed in accordance with NZS4246:2016 Energy Efficiency – Installing Insulation in Residential Buildings. Standards New Zealand has made this Standard freely available for download from their website.

Cutting to Size:

Always cut slightly oversized to ensure a tight friction fit to all surfaces. Premier 100% polyester blankets can be torn across the width by hand. To cut down the length of the roll, we recommend compressing the insulation under a timber off-cut and then cutting through with a sharp wide blade disposable knife. Heavier and higher-density products can be cut using a specialist insulation saw or knife.

Insulate All Areas:

Insulate all areas of the suspended floor from exterior wall to exterior wall leaving no gaps, except as required for electrical and pipe clearances. Small gaps can reduce the overall thermal performance of the construction system. Insulation should extend to the outer edge of the bottom plate wherever possible.

Premier Polyester Underfloor is designed to be installed between timber floor joists. The Underfloor blanket should be wider than the joist cavity with the side edges folded down and stapled at approximately 80mm from the top of the joist. See Fig. 1.

Fit the insulation blanket between the floor joists and adjust so the side edges are equal. Premier Polyester Underfloor should be installed touching the underside of the floor but not compressed.

Figure. 1.

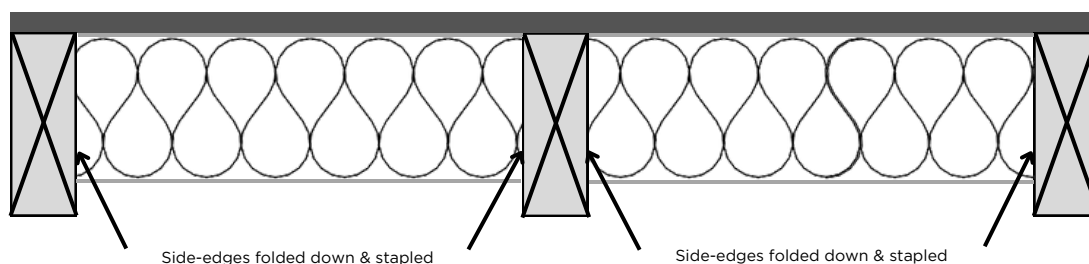

The underfloor blanket should be securely fixed in place by stapling through the insulation material and into the timber joist each side at 200-300mm intervals. Do not staple the insulation directly to the floor as this will compress the insulation thickness and reduce its performance. Staple every 50-100mm for the first 200mm of each joist run.

When joining the end of one roll to the start of another, simply butt join them together ensuring a neat and tight fit and staple in place through the fold-down to the side of the floor joists. Double staple to start then staple every 50-100mm for the first 200mm each side of a join.

PREMIER INSULATION



Clearances:

Leave a clear 100mm gap around waste pipes that penetrate through the floor to allow for future service. See Fig.2

Figure 2.

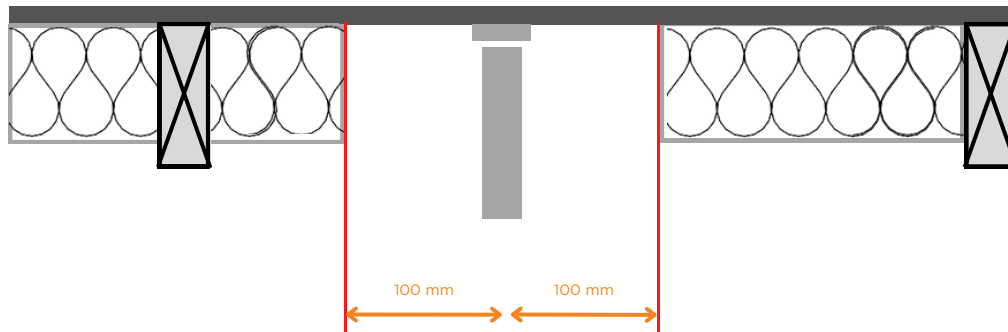

Surface mounted luminaires and lamps:

Follow specified clearances from the luminaire manufacturer. If manufacturers recommendations are unknown, maintain a minimum clearance of 200mm to the luminaire or lamp.

Figure 3.

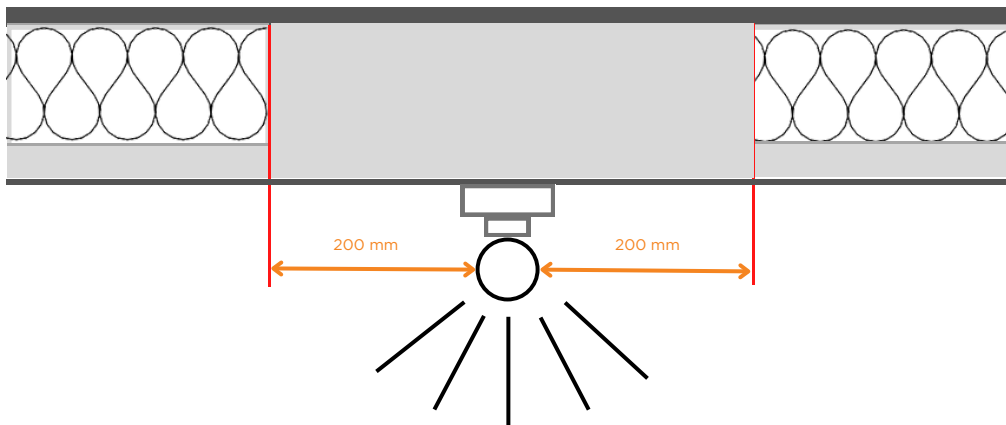
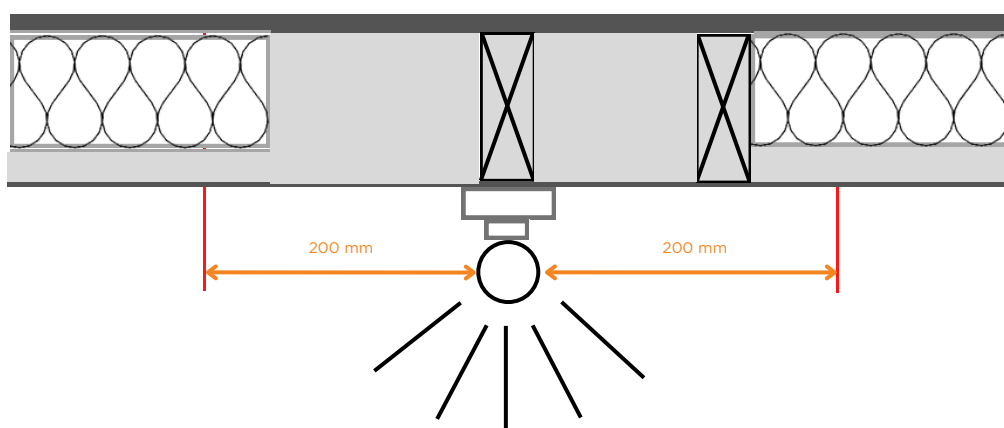

Figure 4 is an example of underfloor insulation installed with clearance around a light fitting mounted to the bottom of a floor joist. On the right hand side a smaller clearance is acceptable as the insulation is fully and permanently shielded by timber framing.

Figure 4.



100% POLYESTER UNDERFLOOR INSTALLATION GUIDE

Figure 5.

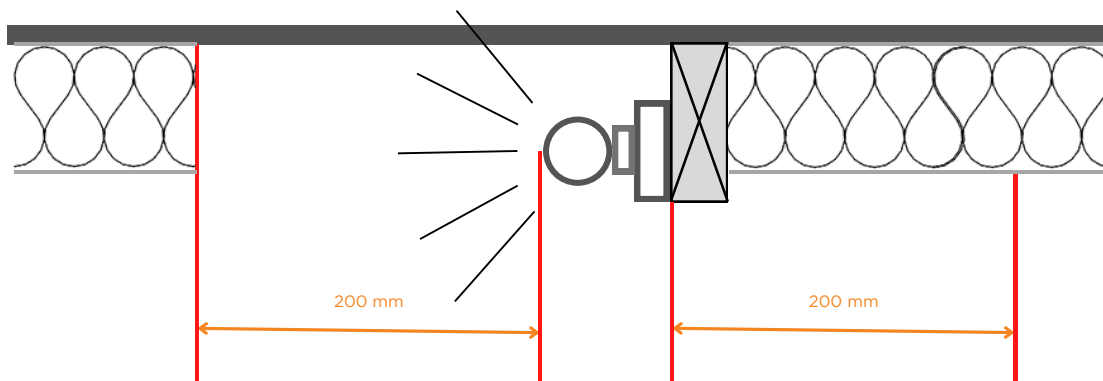

Figure 5 is an example of underfloor insulation installed with clearance around a light fitting mounted to the side of a floor joist.

Maintain a 50mm clearance for brick/concrete chimneys. For other clearances, refer to NZS4246.

Completion:

At the end of the installation, check and repair any visible gaps. Ensure all electrical wiring or cables have not been damaged.

Remove the product label from the packaging and staple it near the access point for possible future inspection.

Specifications & Technical Support

Premier specification documents are available through Masterspec.

For specification or technical support please contact our Technical Team on 0800 467 855, or email support@premierinsulation.co.nz

Premier Insulation
183 Great South Road,
Ngaruawahia, Waikato